

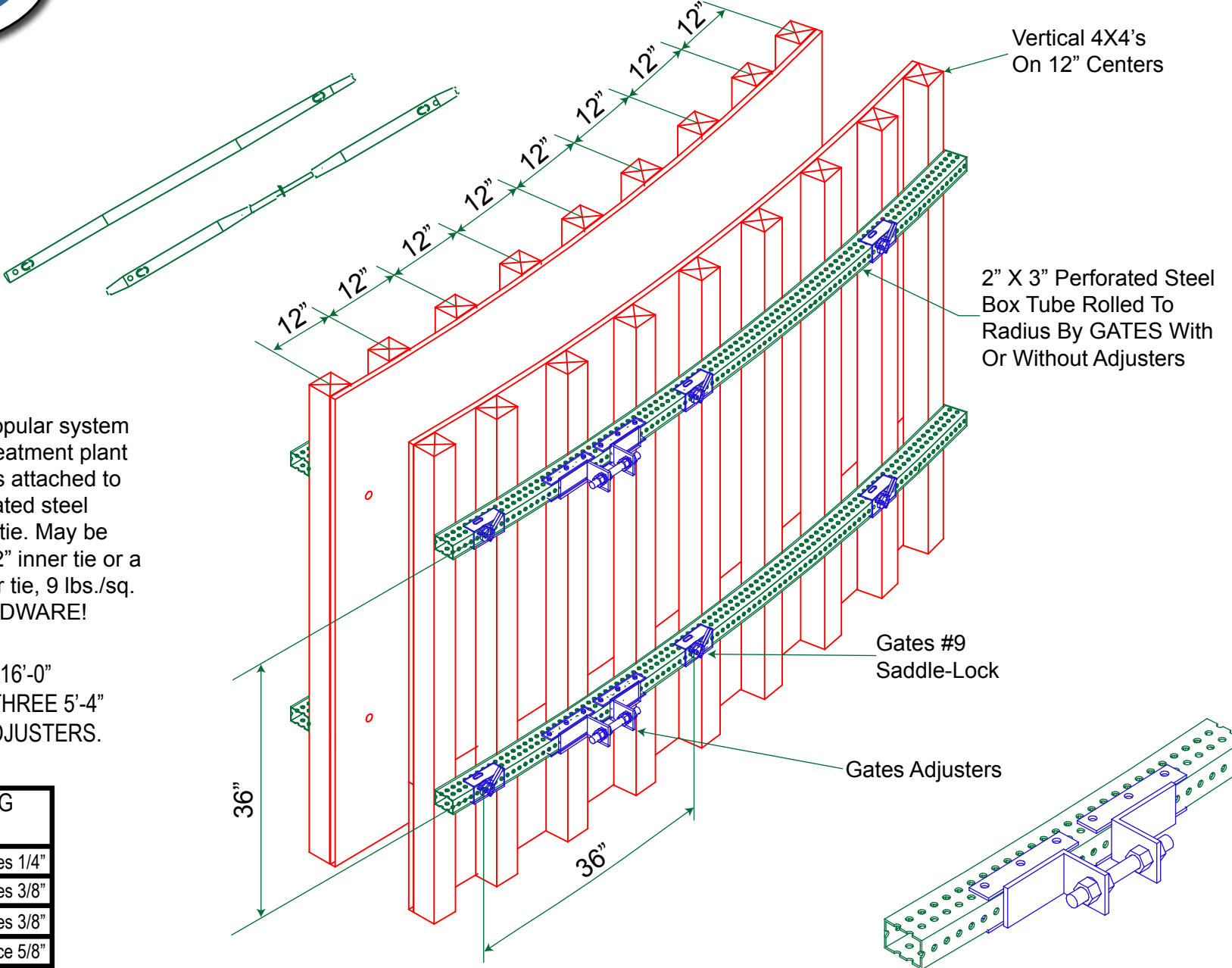

# SUGGESTED #9 ANCHOR-LOCK FORMING DETAILS

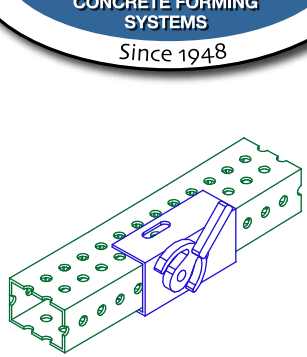

Gates #9 A/L is a very popular system for radius waste water treatment plant work. The Saddle-Lock is attached to the strong 2" X 3" perforated steel radius waler 9 sq. ft. per tie. May be used with a pass-thru 1/2" inner tie or a pass-thru re-usable taper tie, 9 lbs./sq. ft., and NO LOOSE HARDWARE!

SEE GATES CHART FOR 16'-0" WALERS DIVIDED INTO THREE 5'-4" SECTIONS WITH TWO ADJUSTERS.

PLYWOOD BENDING TABLE	
20'-0" Dim.	3 pieces 1/4"
30'-0" Dim.	2 pieces 3/8"
40'-0" Dim.	2 pieces 3/8"
50'-0" Dim.	1 piece 5/8"
60'-0" Dim.	1 piece 3/4"
AND LARGER	